

OIL TEMPERATURE GAUGE INSTRUCTIONS



The following instructions are for the installation of your Tinted Series Oil Temperature Gauge. Before you begin, lay out all items and ensure there are no missing parts. If any items are missing, please STOP immediately and contact GlowShift Gauges.

WHAT'S INCLUDED

- Oil Temperature Gauge
- 1/8-27 NPT Electronic Oil Temp Sensor
- 2' Power Harness
- Mounting Bracket & Hardware
- Gauge Visor

WIRE SCHEMATIC

Red: 12v Ignition (switched) Source (+)

Orange: 12v Dimmer (switched) Source (+)

Black: Vehicle/Engine Ground (-)

Green: Temperature Sensor Signal

⚠ WARNING

Disconnect negative battery terminals before starting any work on the vehicle.

1. Disconnect the vehicle's negative battery cable.
2. Install the oil temperature sensor. There are three common types of oil temperature sensor installations:
 - **Oil Gallery Test Port:** Some engine oil galleries will have a test port plug. Check your owner's manual to verify the location and thread size. Remove the port plug and install the supplied temperature sensor. Additional adapters may be required if the port is not threaded to 1/8th NPT.
 - **Oil Filter Adapter Installation:** You can purchase an Oil Filter Sandwich Adapter from www.GlowShift.com. This oil filter sandwich adapter is installed between your oil filter and engine block, providing you with 3 sensor ports in which you can install the oil temperature sensor.
 - **T-Fitting Installation:** Remove your stock oil temperature sensor and fasten a T-fitting in its place. 1/8th NPT T-fittings are available for purchase at www.GlowShift.com. Using a T-fitting allows you to "T" off of the port and opens up 3 more, which then allows for the stock and GlowShift sensors to be installed and operate simultaneously.
3. Find the location in which you wish to install your Oil Temperature Sensor and have the adapter ready (if required).
4. Place a Catch Pan in the area where you will be working in order to catch any lost oil.
5. Drain the oil pan if needed.
6. Remove any plugs needed to gain access to the oil galley port if installing in that location.
7. Wrap Teflon tape around the threads of the Oil Temperature Sensor and install into the desired location. Tighten using a **14mm wrench**.
8. Plug the Oil Temperature Sensor Harness into the Oil Temperature Sensor and route it through the engine bay and through the firewall, keeping it clear of any moving parts and heat sources.

Note: Be sure to use a grommet when routing the Oil Temperature Sensor Harness through the firewall to protect it from being cut or damaged. If one is not available you will need to drill a hole and install a grommet.

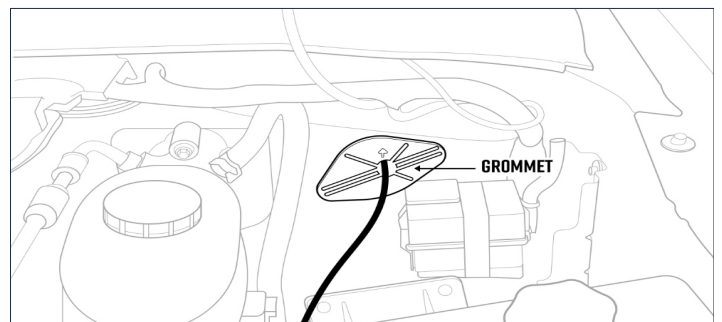

9. Plug the Oil Temperature Sensor Harness into the back of the Oil Temperature Gauge.
10. Splice the **green wire** from the gauge to the **white wire** of the oil temperature sensor.
11. Before starting the engine, be sure to refill/replace any oil lost during the installation process to the manufacturer's specifications.

GAUGE WIRING

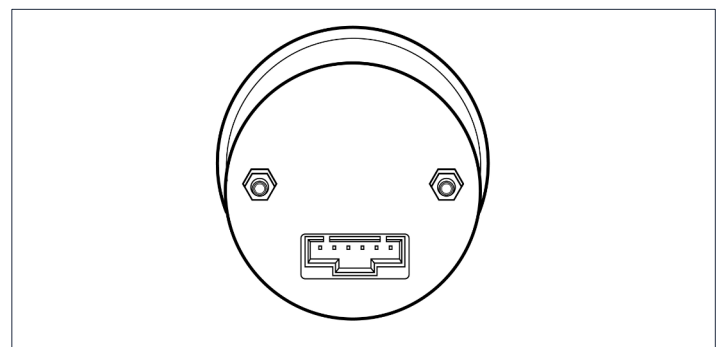

1. To make the wiring of your gauges easier you can purchase an expandable circuit. This component easily fits into your fuse panel and provides an additional fused power wire for accessories such as gauges. The expandable circuit is available for purchase at www.GlowShift.com.
2. Using automotive grade wiring (18 gauge); connect the **red wire** to a positive 12 volt **ignition (switched)** source. It may be connected to the fuse panel, an accessory wire, or any positive 12 volt source that turns on and off with the ignition.

3. Using automotive grade wiring (18 gauge); connect the **black wire** to any reliable (unpainted) ground connection. You may also route a wire directly to the negative side of the vehicle's battery.
 4. The Night Time Dimming feature decreases the brightness of the gauge face by 30%. Connect the **orange wire** to the 12 volt positive headlamp source. This allows the mode to be activated when the headlights come on. This step is optional and will not affect operation of the gauge if it is omitted.
- Note:** Do not connect the orange wire to a dimmer wheel. This will cause the gauge lighting to flicker.
5. Reconnect the vehicle's negative battery cable.
- Note:** Power on the vehicle to ensure the gauge is functioning properly.

GAUGE VISOR

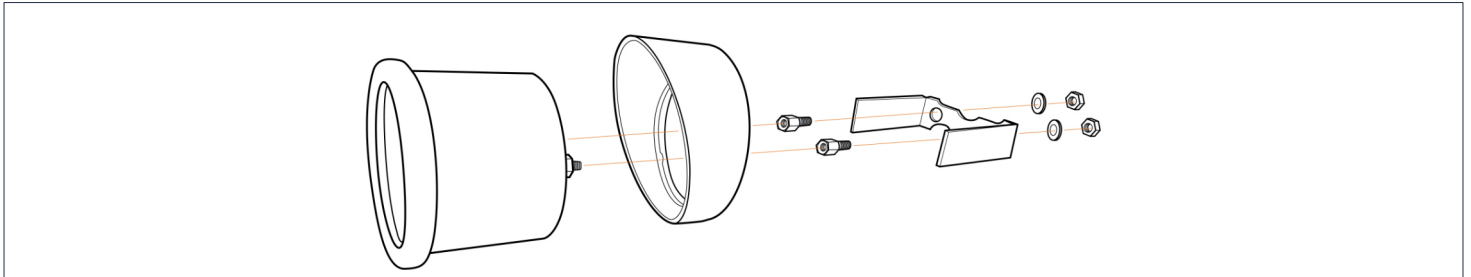

- The supplied optional gauge visor is intended to be placed on the gauge so that the thickest part is at the top, creating a cover over the gauge to help keep sun glare off of the gauge face.
- The included mounting bracket is designed to be used on a flat universal-style mount in order to keep the gauge secure. In some cases one or both legs of the bracket may need to be modified to fit the thickness and contour of the mount.
- Our A-pillar gauge pods do not require the use of the mounting bracket but can be used if you desire, and there is enough space to fit it between the gauge and the gauge pod. When installing the bracket onto the gauge, make sure not to over-tighten as it could pull the rear studs on the back of the gauge and damage it.



INSTALLATION INSTRUCTIONS

856.768.8300 • TechSupport@GlowShiftGauges.com

ONE YEAR NON-TRANSFERRABLE LIMITED WARRANTY & DISCLAIMER

GlowShift Gauges, LLC ("GlowShift") warrants to the original retail consumer purchaser, and not any other purchaser or subsequent owner, that this Product will be free from defects in material or workmanship for a period of **one (1) year** from the purchase date.

For a period of **one (1) year** from the date of purchase, at no charge to the Purchaser, GlowShift will repair or replace this Product if it is determined by GlowShift to be defective. After the warranty period, the Purchaser must pay all charges for parts and labor.

Coverage under this warranty is only valid within the United States, including its territories, as well as in certain other countries. Purchasers should check our website, **www.GlowShift.com**, to determine the warranty coverage in the countries in which they are located.

GlowShift does **not warrant the installation** of the Product, which is the sole responsibility of the Purchaser. Installation should be done by licensed professionals. Improper installation may cause damage to the Product and any vehicle in which it is installed, and may cause burns and electrical injury to individuals. GlowShift's warranty does not cover any expenses incurred in removing Products that are defective or reinstalling replacement Products in their place.

During the warranty period, to have the Product repaired or replaced, the Purchaser must return the Product, freight prepaid by the Purchaser, to GlowShift (but for customers in the contiguous United States, GlowShift will pay the shipping charges if any Product fails during the first sixty (60) days after purchase). The Product must be returned in its original carton or in a similar package affording an equal degree of protection. GlowShift will return the repaired or replaced Product, freight prepaid, to the Purchaser. GlowShift does not provide Purchasers with temporary replacement units during the warranty period or at any other time.

This limited warranty is non-transferrable and will automatically terminate if the original retail consumer purchaser resells the Product or transfers the vehicle in which the Product is installed. An "original retail consumer purchaser" is a person who originally purchases the Product, or a gift recipient of a new Product that is in its original packaging and unopened.

This limited warranty is subject to all of the following terms and conditions:

TERMS & CONDITIONS

1. NOTIFICATION OF CLAIMS; WARRANTY SERVICE: If Purchaser believes that a Product is defective in material or workmanship, written notice with an explanation of the claim shall be given promptly by Purchaser to GlowShift. All warranty claims must be made within the warranty period, and any Products returned to GlowShift must be shipped in accordance with GlowShift's procedures (including use of RMA numbers supplied by GlowShift after notification). The repair or replacement of any Product or part thereof shall not extend the original warranty period. The specific warranty on the repaired part only (not including gauge sensors) shall be in effect for a period of ninety (90) days following the repair or replacement of that part, or the remaining period of the Product warranty, whichever is greater. GlowShift does not provide a warranty on replacement gauge sensors.

2. EXCLUSIVE REMEDY; ACCEPTANCE: Purchaser's exclusive remedy and GlowShift's sole obligation is to supply (or pay for) all labor necessary to repair any Product found to be defective within the repair or replacement fails to remedy the defect. Purchaser's failure to make a claim as provided in paragraph 1 above or continued use of the Product shall constitute an unqualified acceptance of such Product and a waiver by Purchaser of all claims thereto.

3. EXCEPTIONS TO LIMITED WARRANTY: GlowShift shall have no obligation to Purchaser with respect to any Product that is subjected to any of the following: abuse, improper use, negligence, accident, modification, failure to follow the operating procedures outlined in the user's manual, failure to follow the maintenance procedures in the service manual for the Product, attempted repair by non-qualified personnel, operation of the Product outside of the published environmental and electrical parameters, or if the Product's original identification (trademark, serial number) markings have been defaced, altered, or removed. GlowShift excludes from warranty coverage Products sold AS IS and/or WITH ALL FAULTS. GlowShift also excludes from warranty coverage any consumable items such as fuses and batteries.

All software and accompanying documentation furnished with, or as part of the Product is furnished "AS IS" (i.e., without any warranty of any kind), except where expressly provided otherwise in any documentation or license agreement furnished with the Product.

4. PROOF OF PURCHASE; REGISTRATION: The Purchaser's dated bill of sale must be retained as evidence of the date of purchase and to establish warranty eligibility. Registration of any Product or of this limited warranty is voluntary, and failure to register will not diminish any rights available under this warranty.

DISCLAIMER OF WARRANTY

EXCEPT FOR THE FOREGOING WARRANTIES, GLOWSHIFT HEREBY DISCLAIMS AND EXCLUDES ALL OTHER WARRANTIES, EXPRESS OR IMPLIED, INCLUDING, BUT NOT LIMITED TO ANY IMPLIED WARRANTIES OF MERCHANTABILITY, FITNESS FOR A PARTICULAR PURPOSE, OR ANY WARRANTY WITH REGARD TO ANY CLAIM OF INFRINGEMENT THAT MAY BE PROVIDED IN SECTION 2312(3) OF THE UNIFORM COMMERCIAL CODE OR IN ANY OTHER STATE STATUTE.

LIMITATION OF LIABILITY

THE LIABILITY OF GLOWSHIFT, IF ANY, AND PURCHASER'S SOLE AND EXCLUSIVE REMEDY FOR DAMAGES FOR ANY CLAIM OF ANY KIND WHATSOEVER, REGARDLESS OF THE LEGAL THEORY AND WHETHER ARISING IN TORT OR CONTRACT, SHALL NOT BE GREATER THAN THE ACTUAL PURCHASE PRICE OF THE PRODUCT FOR WHICH SUCH CLAIM IS MADE. IN NO EVENT SHALL GLOWSHIFT BE LIABLE TO PURCHASER FOR ANY SPECIAL, INDIRECT, INCIDENTAL, OR CONSEQUENTIAL DAMAGES OF ANY KIND INCLUDING, BUT NOT LIMITED TO, COMPENSATION, REIMBURSEMENT OR DAMAGES ON ACCOUNT OF THE LOSS OF PRESENT OR PROSPECTIVE PROFITS OR FOR ANY OTHER REASON WHATSOEVER.

GOVERNING LAW: This non-transferrable limited warranty shall be governed by the law of the State of New Jersey, U.S.A., and the United States of America, excluding their conflicts of laws principles. The courts of Camden County, New Jersey, shall have the exclusive jurisdiction over any legal action with respect to this warranty.

This limited warranty gives specific legal rights. You may also have other rights that may vary from state to state or from country to country. Some states or countries do not allow the exclusion or limitation of incidental or consequential damages, so the above limitations and exclusions may not apply to you. You are advised to consult applicable state or country laws for a full determination of rights.